

Installation Instructions

Aluminium Venetians

SHORTEN YOUR VENETIANS



1 If the blind is too long, it can be shortened. To this with the blind in place and slats in a level position. Count and mark the amount of excess slats to be removed.

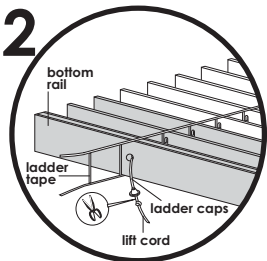

2 Remove ladder caps from the bottom rail with a small flat screwdriver being careful not to damage rail. Cut the knots from the lift cords.

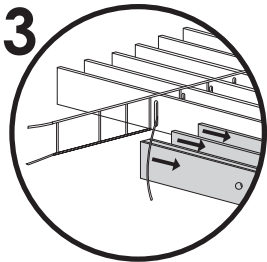

3 Remove the bottom rail and excess slats by first pulling the lift cords up through the slats to be removed and sliding slats out of the ladder tape.

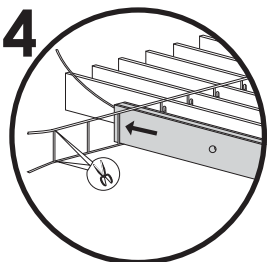

4 Replace the bottom rail into the ladder tape at the desired height allowing one blank ladder rung to remain between the last slat and the bottom rail. This is necessary to allow the last slat to tilt properly.

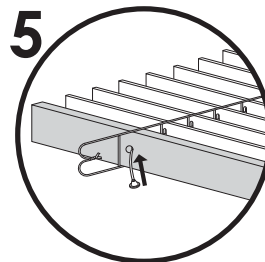

5 Re-insert the lift cords into the holes in the bottom rail. Cut the excess ladder tapes allowing approximately 12mm of excess tape to remain. Thread the lift cords through the ladder caps and tie knots to hold them. Cut the excess cord. Push the excess ladder tape into the holes in the bottom rail. Replace the ladder caps into the bottom rail.

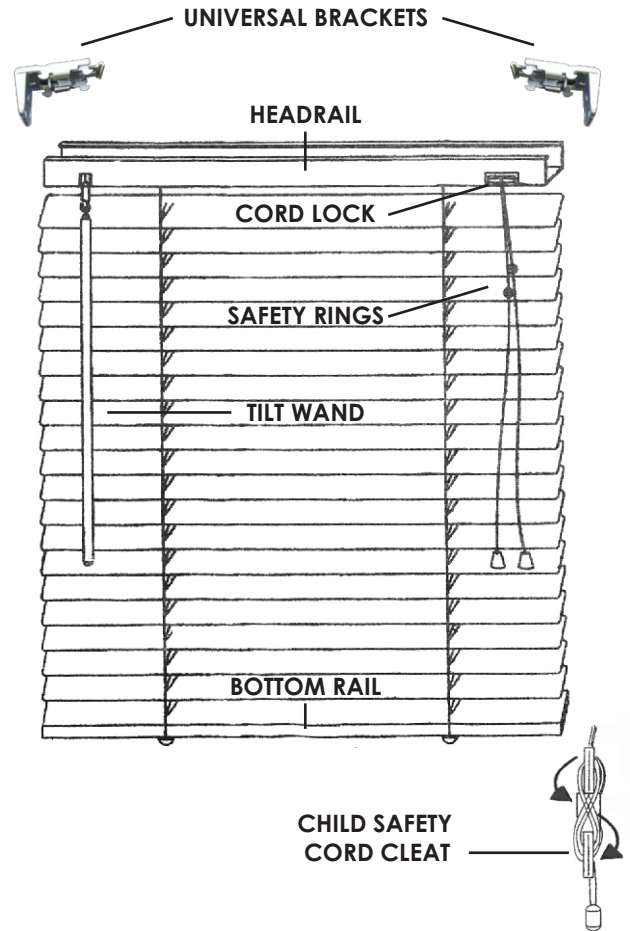

WARNING:

To avoid creating a possible strangulation hazard for children, the corded internal window covering must be installed in such a way that loose cord or ball chain cannot form a loop 220mm or longer as measured along the perimeter of the cord. It should be secured at a height of more than 1600mm above floor level to ensure child safety.

A cord or ball chain guide may be installed lower than 1600mm above floor level, if the cord or ball chain is sufficiently secured or tensioned to prevent a loop of 220mm or longer being formed. If the cord or ball chain guide is installed lower than 1600mm above floor level, it must be installed so as to:

- A. prevent a child from being able to remove the cord or ball chain and;
- B. prevent a loop of 220mm or longer from being formed.

If a cleat is used to secure the cord or ball chain, it must be at least 1600mm above floor level because a child is capable of unwinding cord or ball chain from a cleat.

INSTALLING

STEP 1. Select the method of mounting that best suits your purpose (A, B or C).

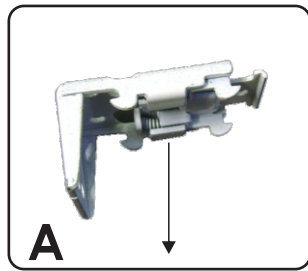

A. Outside mounting to the face or outside the window frame.

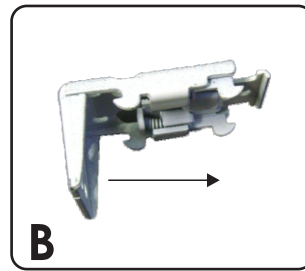

B. Ceiling mounting overhead to a surface such as the top inside of window frame or the ceiling.

STEP 2. Measure where you want the blind to hang, make sure that the blind is centred and level. Hold one bracket at desired height and width you have chosen and mark the screw holes with a pencil.

STEP 3. Drill pilot holes where you marked the screw holes. Use a screwdriver to attach the brackets to the wall or roof using the necessary screws.

STEP 4. After the first bracket is mounted, carefully position and attach the second bracket. Double check to be sure that it is level and aligned with the first bracket and that both are the correct distance apart.

STEP 5. Pick up the blind and clip underneath the brackets (see fig 1). Make sure that the blind cord and the tilt cord collar face toward you.

STEP 6. Place the front hooks of the brackets to the inside front edge of the head rail (2A). Then rotate the head rail up into the rear of the bracket and lock into place (see fig 2B).

STEP 7. Position hold down brackets at the base of the blind and mark the screw holes with a pencil. Drill pilot holes where you marked the screw holes. Use a screwdriver to attach the hold down brackets to the wall using the necessary screws (see fig 3).

STEP 8. Attach Child Safety Cord Cleat where required to prevent tangling or child strangulation.

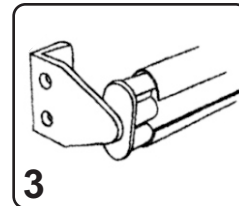
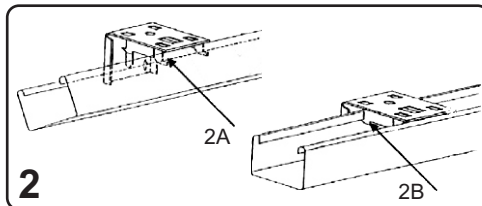
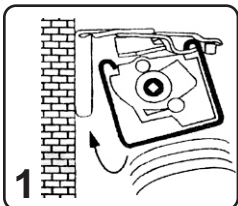

OPERATION

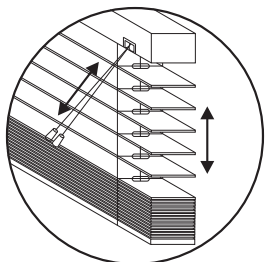

LOWERING: Pull cord downward until blind reaches desired height and release the cord; blind will lock automatically.

RAISING: Hold cord at eye level and move to left gently until cord lock releases. Allow cord to slip through fingers until blind reaches desired level. Move pull cord to the right and release; blind will lock automatically.

TILTING: For tilting the angle of the slats, pull either of the tilt cords to adjust the amount of light or privacy required.

Always tilt slats horizontally before raising or lowering the blind to increase the life of your venetian.

ALL FITTINGS INCLUDED

